



ISOPAR® ELEGANT

INSULATING PANEL WITH HIDDEN FASTENERS

The look of a wall is important. Lattonedil® combines the beauty of an architectural wall with hidden fasteners and the practicality of a modular design. The maze-like design and the hot-cut joint with a special housing for the fasteners offers an

excellent aesthetic result, with the fasteners completely hidden from view, keeping airflows and cold bridges away. Ideal for false ceilings and insulated walls. For panel with a smooth finish, we recommend using a 0.6 mm thickness steel support.

THICKNESS FROM 50 TO 240 MM

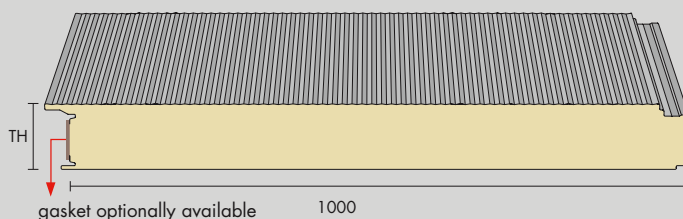

OUTER SIDE

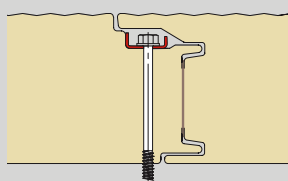

INNER SIDE



Horizontally panel assembly



Vertically panel assembly

During the assembly phase, use the steel fastening plate. The plate is intended to distribute the efforts arising from fixing and to increase the resistance to compressive and depression stresses acting on the wall panels. The position and the number of fixing points must be defined by the designer depending on the stresses on the structure.

Available profiles (please state when ordering)

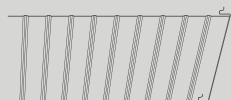

Scored



Staved

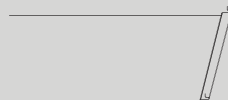

Smooth



Diamond

U Transmittance	50	60	80	100	120	150	180	200	220	240
W/sq.m. K	0.44	0.37	0.28	0.22	0.19	0.15	0.12	0.11	0.10	0.09
Kcal/sq.m. h °C	0.38	0.32	0.24	0.19	0.16	0.13	0.11	0.10	0.09	0.08

Hex head screw with 8mm key.